

FLOOR PLAN SHEET NOTES

1. EXTERIOR DIMENSION AT PRECAST ARE TO FACE OF PRECAST.
2. INTERIOR DIMENSIONS INDICATED ARE TO FACE OF FINISH AND CENTERLINES OF COLUMNS, UNLESS NOTED OTHERWISE.
3. LOCATE DOOR OPENINGS 4" FROM NEAREST PERPENDICULAR WALL OR CENTER ON WALL.
4. FIRE AND SOUND RATED WALLS/PARTITIONS TO BE CONSTRUCTED TIGHT TO STRUCTURE, PIPING, DUCTWORK AND OTHER PENETRATIONS. ALL WORK IS TO BE BRACED TO STRUCTURE ABOVE.
5. WHERE PARTITIONS OF DIFFERENT FIRE RATINGS INTERSECT, THE HIGHEST RATED PARTITION SHALL CONTINUE THROUGH. MAINTAIN PARTITION FIRE RATING BEHIND RECESSED FIRE EXTINGUISHER CABINETS.
6. INSTALL BLOCKING IN PARTITIONS FOR CASEWORK, WALL MOUNTED EQUIPMENT, TRIM AND RELATED CONSTRUCTION AS INDICATED IN THE SPECIFICATIONS.
7. SEE LIFE SAFETY PLANS FOR REQUIRED FIRE SEPARATION WALLS.
8. SEE SHEET A-1003 FOR PARTITION TYPES.
9. SEE AI SHEETS FOR CASEWORK SCHEDULES, DESIGNATIONS & DETAILS.
10. SEE AI SHEETS FOR INTERIOR ELEVATIONS, ACCESSORY DESCRIPTIONS & MOUNTING HEIGHTS.
11. SEE AI SHEETS FOR FINISH FLOORING, TRANSITIONS, PATTERNS AND WALL PROTECTION.
12. SEE AI SHEETS FOR FINISH SCHEDULE.
13. SEE A-400's AND AI SHEETS FOR ENLARGED PLANS INDICATING ADDITIONAL DIMENSIONS AND PARTITION TYPES.
14. SEE SHEET A-561 FOR MISS PARKING DETAILS.
15. SEE A-160'S AND STRUCTURAL DRAWINGS FOR SLAB DEPRESSIONS AND CUTOUTS.
16. SEE SHEET A-563 FOR ADDITIONAL SIGNAGE DETAILS AND REQUIREMENTS.
17. K-13 INSULATION OR EQUAL SPRAY INSULATION (R-16.7) AT UNDERSIDE OF ALL UNCONDITIONED SPACES WITH OCCUPIED SPACE ABOVE UNDO
18. SEE A-133 AND A-133 FOR PARTITION PLANS.

PARTITION NOTES

1. ALL NON-DESIGNATED PARTITIONS SHALL BE TYPE A6N0.
2. ALL PIPE AND CONDUIT PENETRATIONS THRU 2 HR RATED OR MORE PARTITIONS, FLOORS, ROOF, ETC. SHALL BE SEALED WITH A RESPECTIVELY RATED FIRE BARRIER PENETRATION SEALING SYSTEM BY 3M OR U.L. APPROVED EQUAL.
3. TILE BACKER BOARD SHALL BE USED IN ALL LOCATIONS TO RECEIVE TILE FINISHES. REFER TO FINISH SCHEDULE AND INTERIOR ELEVATIONS FOR LOCATIONS.
4. CONTRACTOR SHALL COORDINATE WITH MECHANICAL DUCTWORK PRIOR TO FABRICATION OF PARTITION WALLS.
5. SHOULD CONDITIONS OCCUR WHERE A WALL IS UNABLE TO GO STRAIGHT UP TO STRUCTURE DUE TO PIPING, DUCTWORK, ETC., THE PARTITION GYPSUM BOARD AND FRAMING MAY JOG HORIZONTALLY ABOVE THE CEILING TO AVOID THE PROBLEM. RATED WALL INTEGRITY SHALL BE MAINTAINED.
6. WHERE STUDS EXTEND TO STRUCTURE AND GYPSUM WALLBOARD EXTEND JUST ABOVE THE FINISH CEILING, CAP OFF PARTITION FINISHES WITH A RUNNER CHANNEL WHEN CEILING PLENUM IS USED AS A RETURN AIR PLENUM.
7. DIMENSIONAL CONFLICTS BETWEEN PARTITION TYPES AND THE ARCHITECTURAL FLOOR PLANS SHALL BE BROUGHT TO THE ATTENTION OF THE ARCHITECT.
8. REFER TO UNDERWRITERS LABORATORIES, INC. FIRE RESISTANCE VOLUMES - CURRENT EDITION FOR SPECIFIC CONSTRUCTION REQUIREMENTS OF U.L. LISTED ASSEMBLIES.
9. REFER TO MECHANICAL, ELECTRICAL AND PLUMBING DRAWINGS FOR TYPICAL U.L. LISTED PENETRATIONS THROUGH FIRE-RATED ASSEMBLIES. CONTRACTOR SHALL BE RESPONSIBLE FOR PROVIDING APPROPRIATE PROJECT-SPECIFIC U.L. LISTED ASSEMBLIES FOR PENETRATIONS.
10. REFER TO MECHANICAL SHEETS FOR TYPICAL DETAILS AT FIRE DAMPERS IN RATED WALLS. COORDINATE EXACT FRAMING REQUIREMENTS WITH FIRE DAMPER MANUFACTURER. (COORDINATE ALL PARTITION CONSTRUCTION WITH MECHANICAL PRIME CONTRACTOR PRIOR TO COMMENCING PARTITION CONSTRUCTION).
11. AT ALL EXISTING AND CONSTRUCTED PARTITIONS THE CONTRACTOR IS TO MAINTAIN THE FIRE-RESISTIVE INTEGRITY.

PARKING COUNT				BIKE PARKING COUNT		
LEVEL	TYPE	COUNT	TOTAL	TYPE	REQ'D PER UDD 10.3.3	PROVIDED
LOWER	STANDARD	72	77	LONG-TERM	93	117
	COMPACT	5		SHORT-TERM	23	26
GROUND	STANDARD	SITE 6	6	TOTAL	116	140
P2	ADA	4	43	NOTE: TOTAL REQ'D PARKING PER UDD 10.3.3 INCLUDES SPACES NOT REQ'D TO BE DESIGNATED AS SHORT-TERM OR LONG-TERM		
	ADA VAN	2				
	COMPACT	5				
	STANDARD	32				
P3	ADA	1	84			
	COMPACT	13				
	STANDARD	70				
P4	ADA	1	84			
	COMPACT	13				
	STANDARD	70				
P5	ADA	1	81			
	COMPACT	15				
	STANDARD	65				
P6	ADA	1	78			
	COMPACT	17				
	STANDARD	61				
TOTAL: 453						

PARTITION LEGEND

- NON-RATED PARTITION TO CEILING
 - NON-RATED PARTITION TO DECK
 - 1 HR. RATED PARTITION TO DECK
 - 2 HR. RATED PARTITION TO DECK
 - 4 HR. RATED PARTITION TO DECK
- NOTE: SEE SHEET A-1003 FOR CONSTRUCTION OF PARTITION TYPES.

KEY PLAN

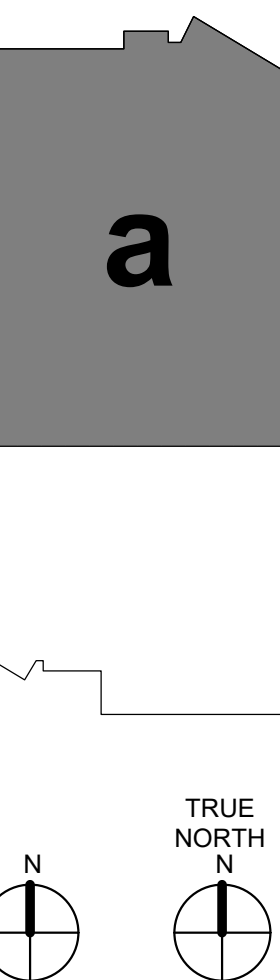

ALP AUSTIN LAWRENCE PARTNERS

THE NOVUS

LS3P

227 WEST STREET SUITE 700
CHARLOTTE, NORTH CAROLINA 28202
TEL. 704.333.6686 FAX 704.333.2926
WWW.LS3P.COM

LS3 ASSOCIATES LTD.
CERT. NO. 50417
CHARLOTTE, NORTH CAROLINA

6666
WITH CAROLINA
12 JULY 2025

MEMBERS OF THE AMERICAN INSTITUTE OF ARCHITECTS

COPYRIGHT 2021 ALL RIGHTS RESERVED
PRINTED OR ELECTRONIC DRAWINGS AND DOCUMENTATION MAY NOT BE REPRODUCED IN ANY FORM WITHOUT WRITTEN PERMISSION FROM LS3 ASSOCIATES LTD.

REVISIONS:

No.	Description	Date
1	CCD-004	8/23/2022
2	CCD-005	9/23/2022
3	CCD-007	11/18/2022
4	CCD-010	12/5/2022
5	CCD-012	3/13/2023
6	CCD-018	1/17/2024
7	BULLETIN 02	7/16/2024
8	CCD-019	9/11/2024
9	BULLETIN 22	02/21/2025
10	CCD-022	03/14/2025
11	BULLETIN 27	5/13/2025
12	BULLETIN 30	7/14/2025

PROJECT: 9512-172950
DATE: 03/24/2025
DRAWN BY:
CHECKED BY:

GROUND FLOOR PLAN - a

A-101a

Autodesk Docs:09512-172950 Austin Lawrence Partners - Five Points/Arch. 5 Points - Core and Shell_1/2022.rvt
7/14/2025 4:19:42 PM

A1 01_GROUND FLOOR PLAN - a
1/8" = 1'-0"